



7800ELD

Head Assembly

Installation Instructions

STEP #1

Required Parts:

1	Extruded Roller Bar (2365)	1	Direct Drive Motor with Cover (61L)
1	3/4" Extension Shaft (2838)	1	ELD Motor Switch Kit (85N)
1	Wind Deflector (2 sections) (1647)	1	3/4" Shaft Collar (148)
1	Bearing Plate (3221)	25'	Dual Conductor 8ga. Wire
1	Bearing Plate with 3/4" Flange Bearing (8004)	1	Contact Plate Kit (1379A)

Optional: Solenoid Switch Kit (1495) 800w Motor (4422)

Before beginning installation:

- 1) Check parts bags for correct contents. Contact your dealer if parts are missing. **THE LAST PAGE CONTAINS THE REFERENCE GUIDE FOR THE HARDWARE YOU WILL NEED TO INSTALL YOUR SYSTEM.**
- 2) Read through instructions for entire system to get a general idea of how each component is mounted and how the components fit together.

Choosing the Mounting Location

In general, the rollerbar should be mounted on top of the trailer and as far forward as possible so that the direct drive motor and pivot arms will be less likely to be damaged by loaders. If you are installing a wind deflector, be sure to leave enough space between the deflector and the rollerbar so that there is sufficient room for the entire tarp when it is rolled up.

Installing the Bearing Plates

- 1) Once the mounting location has been determined, install the included bearing plates using the 3/8" x 1-1/2" bolts, flat washer, split lock washer, and nuts.
- 2) Be sure there is enough clearance between the rollerbar and the wind deflector to roll-up the entire tarp.

Installing the Wind Deflector (Optional)

Install the wind deflector halves to the cab shield using the 3/8 x 1-1/2" bolts, flat washers & lock nuts. Mount the wind deflector forward of the rollerbar allowing enough space between the wind deflector and the rollerbar for the tarp when it is fully rolled up. One or both halves may need cutting to fit the width of the trailer.

Mounting the Direct Drive Motor and Rollerbar

- 1) Mount the DD motor to the bearing plate or cab shield.
- 2) Measure from the inside of one bearing plate to the inside of the other. Cut the roller bar one inch shorter than this length. Ensure you do not cut off the end with the pre-drilled hole.
- 3) Drill a 5/16" hole, 1/2" from the cut end of the rollerbar. Start the hole in one of the smooth-sided slots, **not** a threaded slot (see Figure 1). Slide one end of the rollerbar over the DD motor output shaft and secure with a 5/16" carriage bolt, washer, and lock nut.
- 4) Slide the extension shaft through the bearing plate and into the roller bar. Line up the holes in the roller bar with the hole in the extension shaft and secure with the 5/16 carriage bolt, washer, and lock nut.
- 5) Install a 3/4" shaft collar onto the extension shaft on the outside of the 3/4" bearing to prevent lateral movement of the roller bar.

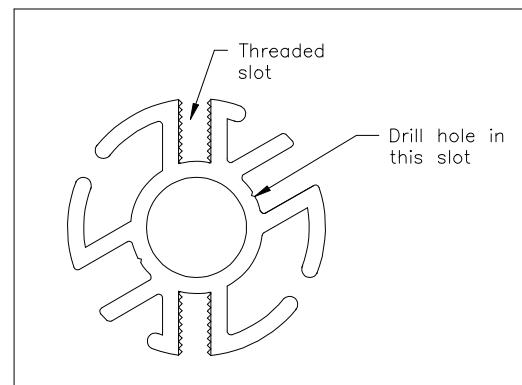

FIGURE 1

Installing Contact Plate Assembly

Follow the instructions that come with the contact plate assembly to install your contact plate and properly hook up the electrical wires that will operate your tarping system.

Wiring the Motor

Follow the instructions supplied with your electrical switch kit.

7800ELD

Pivot Mount Installation Instructions

STEP #2

Contents of Kit:

2 Pivot Arm Mounts 2 Torsion Springs (left and right)

Installing the Underbody Pivot Arm Mounts

- 1) To find the pivot point, pull one tape measure from point "A" and a separate tape measure from point "B". Next, cross the tape measures at the bottom-middle of the trailer where the two measurements are equal. Mark the spot beneath where they cross. This is your pivot point. (See Figure 2)

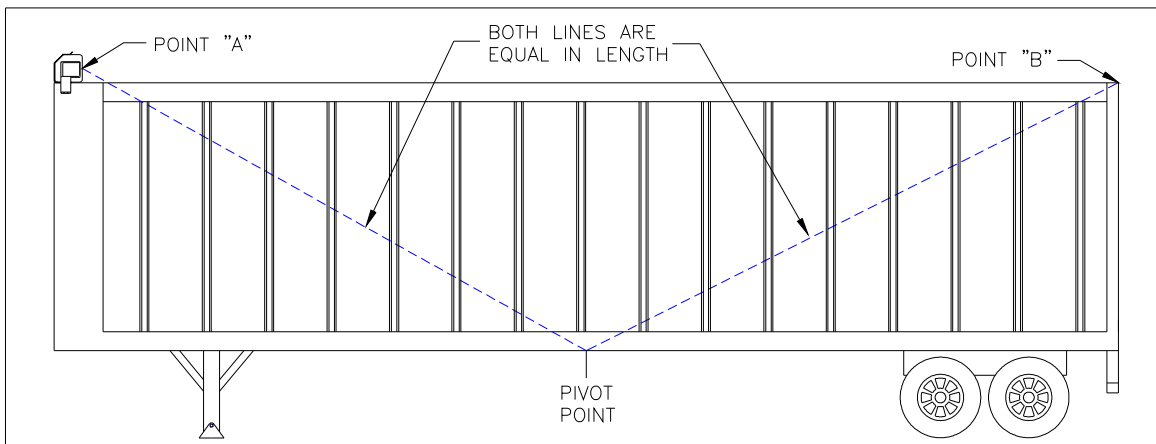

FIGURE 2

- 2) Weld the pivot mounts into place at the pivot point determined in step 1. **Note: The pivot mounts are directional.** (Figure 3 shows the drivers side pivot assembly. Ensure the bend on the pivot mount is towards the front of the truck.)

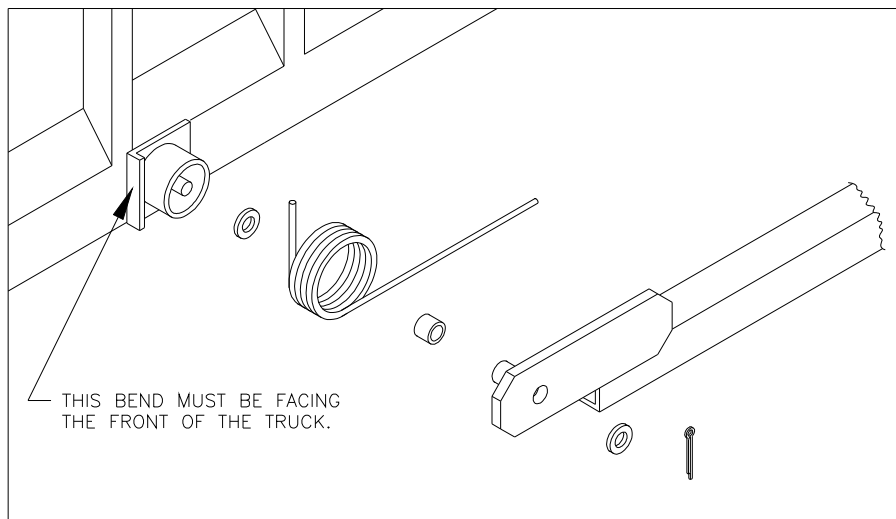

FIGURE 3

7800ELD

Pivot Arm Installation Instructions

STEP #3

Contents of Kit:

2	Upper Pivot Arms	1	Rear Cross Piece (RCP)
2	Pivot Arm Rests	2	Lower Pivot Arms

Installing the Pivots Arms

- 1) Assemble the lower arm unit using the included pivot mount washers, torsion springs, bearings, and cotter pins as shown previously in figure 2.
- 2) Slide one of the upper pivot arms into a lower arm. Adjust the arm length until the corner rests on the desired landing point at the back of the trailer and at the head assembly. If the upper arm is too long, cut both upper arms to allow at least 2 feet of upper pivot arm sticking into the lower pivot arm. (See figure 4)
- 3) Slide the other upper pivot arm into the lower pivot arm (make sure that both arms end up the same length).
- 4) Drill one 1/4" hole through each lower arm where the upper and lower arms overlap. Secure the upper and lower arms using the cotter pins included in the hardware kit.
- 5) Measure the distance between the upper arms as in Figure 5. Cut one end of the rear cross piece 4" shorter than the distance measured as Dimension "A" in Figure 5.
- 6) Slide the ends of the rear cross piece (RCP) over the upper pivot arm ends.
- 7) Drill a 1/4" hole through each end of the rear cross piece and upper arm bends to allow the RCP to be secured after tarp installation.

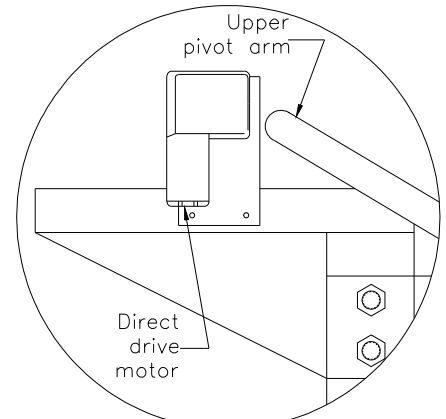

FIGURE 4

Installing the Tarp

- 1) In order to ensure your system is aligned as desired and to determine the mounting position of the pivot arm rests, it is recommended to install the tarp at this time.
- 2) Thread the tarp spline into the aluminum rollerbar. (Make sure to remove excess spline or it may hinder the system's operation).
- 3) Thread the tarp pocket (sewn into the tarp) onto the RCP.
- 4) Center the tarp on both aluminum roller bar and rear cross piece.
- 5) Cotter pin the Rear Cross Piece back on to the 90° bend in the upper arm.
- 6) Check all mechanism bolts and screws for security.

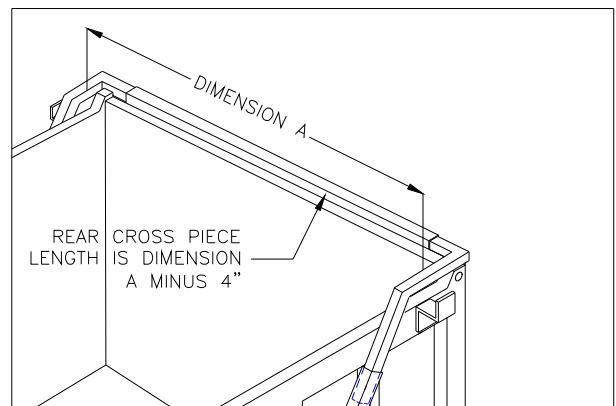

FIGURE 5

Installing the Pivot Arm Rests

- 1) Unwind the tarp so that the system is in the "covered" configuration.
- 2) Position the pivot arm rests so that upper arms rest evenly and do not make contact with the tailgate or any other part of the dump body.
- 3) Weld or bolt pivot arm rests into place.

7800 ELD Hardware Kit

Description	QTY	Part#
<u>Bearing Plate Mounting hardware</u>		
3/8" x 1-1/2" Bolt	4	2464
3/8" Hex nut	4	2873
3/8" Flat washer	4	2875
3/8" Split lock washer	4	2872
<u>Wind deflector hardware</u>		
3/8" x 1-1/2" Bolt	4	2464
3/8" Lock nut	4	2874
3/8" Flat washer	8	2875
<u>Rear Cross Piece to Arms hardware</u>		
1/4" x 3" Cotter pins	2	2475
<u>Upper Arm to Lower Arm hardware</u>		
1/4" x 3" Cotter pins	2	2475
<u>Pivot Mount hardware</u>		
1" Oil impregnated bearing	2	1665
1/4" x 3" Cotter pins	2	2475
1" Flat washer (2-1/2" OD)	4	182
<u>Rollerbar hardware</u>		
5/16" Lock nuts	2	2868
5/16" x 2-1/2" Carriage bolt	2	373
5/16" Flat washer	2	2867
3/4" Shaft collar	1	40
<u>Switch Kit hardware</u>		
#10 Sheet metal screws	2	2476
1/4" Washer	2	2457
<u>Motor and Cover hardware</u>		
5/16" x 3/4" bolt	3	2418
"U" nuts	5	3708
#8 Sheet metal screw	5	3709

Any Questions?????.....Call us @ 1-800-327-8287