



# 7800GL

## Head Assembly

### Installation Instructions

# STEP #1

#### Required Parts:

2	3/4" Shaft Collar (148)	1	Extruded Rollerbar (2365)
1	3/4" Extension Shaft with Sprocket (2403)	1	3/4" Extension Shaft (2838)
1	7000GL Control Box Assembly (780/1609)	1	Wind Deflector (2 sections) (1647)
1	Chain Guard, Upper (790)	1	Chain Guard, Lower (791)
3	Chain Guard Bracket (1412)	2	Bearing Plate w/ 3/4" Flange Bearing (3678)
1	Mounting Instructions, Operating Manual & Warranty		

#### Before beginning installation:

- 1) Check parts bags for correct contents. Contact your dealer if parts are missing. **THE LAST PAGE CONTAINS THE REFERENCE GUIDE FOR THE HARDWARE YOU WILL NEED TO INSTALL YOUR SYSTEM.**
- 2) Read through instructions for entire system to get a general idea of how each component is mounted and how the components fit together.

#### Choosing the Mounting Location

In general, the rollerbar should be mounted on top of the trailer and as far forward as possible so that the direct drive motor and pivot arms will be less likely to be damaged by loaders. If you are installing a wind deflector, be sure to leave enough space between the deflector and the rollerbar so that there is sufficient room for the entire tarp when it is rolled up.

#### Installing the Bearing Plates

- 1) Once the mounting location has been determined, install the included bearing plates using the 3/8" x 1-1/2" bolts, flat washer, split lock washer, and nuts.
- 2) Be sure there is enough clearance between the rollerbar and the wind deflector to roll-up the entire tarp.

#### Mounting the GL Control Box

- 1) Determine suitable position for mounting GL control box to front driver's side of trailer. Keep in mind that the top sprocket and bottom sprocket must be aligned vertically without any obstacles to obstruct movement of the chain or crank handle.
- 2) Mount control box to side wall of body using 3/8" x 1-1/2" bolts, lock nuts, and flat washers.

#### Mounting the Rollerbar

- 1) Measure from the inside of one bearing plate to the inside of the other. Cut the roller bar one inch shorter than this length.
- 2) Drill a 3/8" hole, 1/2" from each end of the rollerbar. Start the hole in one of the smooth-sided slots, **not** a threaded slot (see Figure 1).
- 3) Slide the extension shaft through the curb-side bearing plate and into the roller bar. Line up the holes in the roller bar with the hole in the extension shaft and secure with the 5/16 carriage bolt, flat washer, and lock nut.
- 4) Install a 3/4" shaft collar onto the extension shaft on the outside of the 3/4" bearing to prevent lateral movement of the roller bar.
- 5) Slide the 3/4" shaft collar on the extension shaft with the sprocket and then slide the extension shaft through the bearing plate and into the roller bar. Align the sprocket by sliding the shaft into or out of the rollerbar such that when the chain is installed, it is going straight up from the control box to rollerbar sprocket. Tighten shaft collar set screw.
- 6) Using the hole you drilled in step 2 as a guide, drill a 3/8" hole through the sprocket shaft. Secure the shaft to the rollerbar using a 5/16" x 2-1/2" carriage bolt, flat washer, and lock nut.

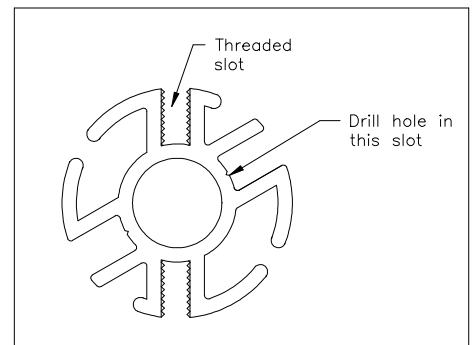

FIGURE 1



- 2) Weld the pivot mounts into place at the pivot point determined in step 1. **Note: The pivot mounts are directional.** (Figure 3 shows the drivers side pivot assembly. Ensure the bend on the pivot mount is towards the front of the truck.)

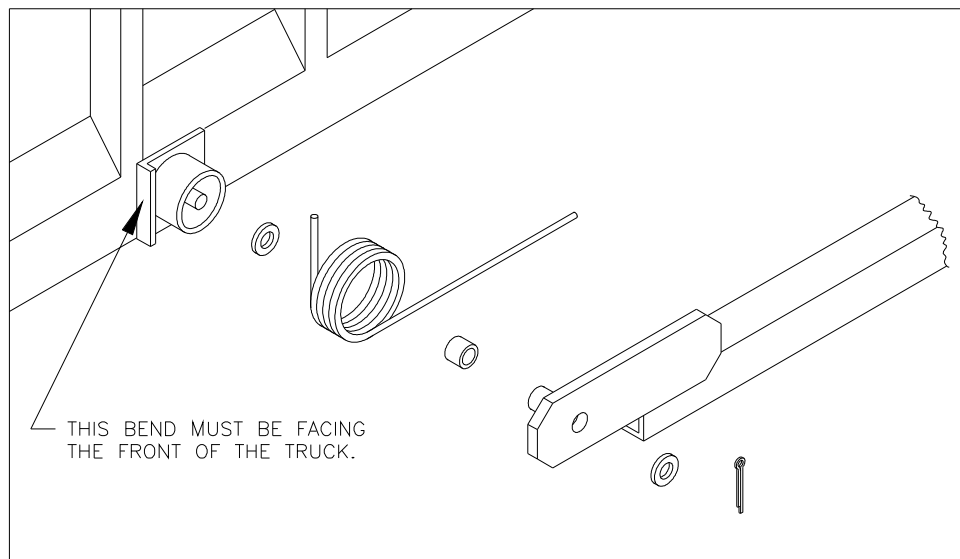

FIGURE 3

## 7800GL

### Pivot Arm Installation Instructions

## STEP #3

#### Contents of Kit:

2	Upper Pivot Arms	1	Rear Cross Piece (RCP)
2	Pivot Arm Rests	2	Lower Pivot Arms

#### Installing the Pivots Arms

- 1) Assemble the lower arm unit using the included pivot mount washers, torsion springs, bearings, and cotter pins as shown previously in figure 3.
- 2) Slide one of the upper pivot arms into a lower arm. Adjust the arm length until the corner rests on the desired landing point at the back of the trailer and at the head assembly. If the upper arm is too long, cut both upper arms to allow at least 2 feet of upper pivot arm sticking into the lower pivot arm. (See figure 4)
- 3) Slide the other upper pivot arm into the lower pivot arm (make sure that both arms end up the same length).
- 4) Drill one 1/4" hole through each lower arm where the upper and lower arms overlap. Secure the upper and lower arms using the cotter pins included in the hardware kit.

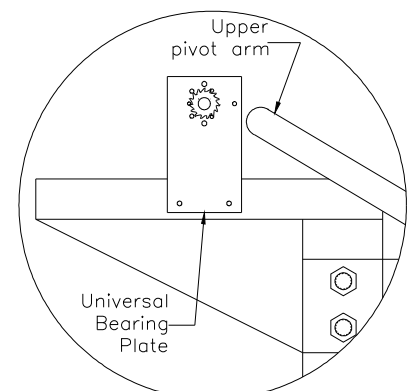

FIGURE 4

- 5) Measure the distance between the upper arms as in Figure 2. Cut one end of the rear cross piece 4" shorter than the distance measured as Dimension "A" in Figure 5.

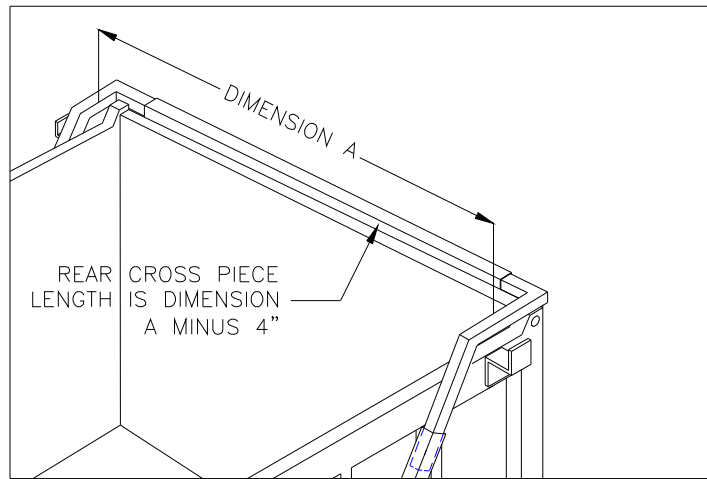

FIGURE 5

- 6) Slide the ends of the rear cross piece (RCP) over the upper pivot arm ends.
- 7) Drill a 1/4" hole through each end of the rear cross piece and upper arm bends to allow the RCP to be secured after tarp installation.

### **Installing the Tarp**

- 1) In order to ensure your system is aligned as desired and to determine the mounting position of the pivot arm rests, it is recommended to install the tarp at this time.
- 2) Thread the tarp spline into the slot routed out in the middle of the aluminum rollerbar. (Make sure to remove excess spline or it may hinder the system's operation).
- 3) Thread the tarp pocket (sewn into the tarp) onto the RCP.
- 4) Center the tarp on both aluminum roller bar and rear cross piece.
- 5) Cotter pin the Rear Cross Piece back on to the 90° bend in the upper arm.
- 6) Check all mechanism bolts and screws for security.

### **Installing the Pivot Arm Rests**

- 1) Unwind the tarp so that the system is in the "covered" configuration.
- 2) Position the pivot arm rests so that upper arms rest evenly and do not make contact with the tailgate or any other part of the dump body.
- 3) Weld or bolt pivot arm rests into place.

## 7800 GL Hardware Kit

Description	QTY	Part#
<b><u>Bearing Plate Mounting hardware</u></b>		
3/8" x 1-1/2" Bolt	4	2464
3/8" Hex nut	4	2873
3/8" Flat washer	4	2875
3/8" Split lock washer	4	2872
<b><u>Wind deflector hardware</u></b>		
3/8" x 1-1/2" Bolt	4	2464
3/8" Lock nut	4	2874
3/8" Flat washer	8	2875
<b><u>Rear Cross Piece to Arms hardware</u></b>		
1/4" x 3" Cotter pins	2	2475
<b><u>Upper Arm to Lower Arm hardware</u></b>		
1/4" x 3" Cotter pins	2	2475
<b><u>Pivot Mount hardware</u></b>		
1" Oil impregnated bearing	2	1665
1/4" x 3" Cotter pins	2	2475
1" Flat washer (2-1/2" OD)	4	182
<b><u>Rollerbar hardware</u></b>		
5/16" Lock nuts	2	2868
5/16" x 2-1/2" Carriage bolt	2	373
5/16" Flat washer	2	2867
3/4" Shaft collar	1	40
<b><u>Miscellaneous hardware</u></b>		
Chain, #40 x 10'	1	793
Sprocket 40A, 18" x 3/4"	1	2403
<b><u>GL Control Box hardware</u></b>		
3/8" Flat washer	6	2875
3/8" x 1-1/2" Bolt	3	2464
3/8" Lock nut	3	2874
<b><u>Chain Guard Mounting hardware</u></b>		
1/4" x 1/2" Bolt	2	1911
1/4" Lock washer	12	2458
1/4" x 3/4" Self drilling screws	12	3299
3/8" x 1/2" Bolt	2	1913
3/8" Lock nut	2	2874

**Any Questions?????.....Call us @ 1-800-327-8287**